

# ABI Wimbledon 2023

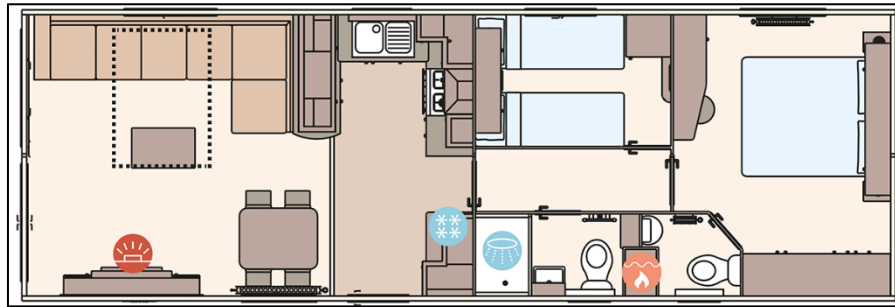

From its traditional looking hearth and bedroom wall lights to classic ceramic handled taps, the Wimbledon has a certain period charm. Simultaneously quaint and stylish, its dusky neutral palette adds a little hint of modernity to its character.

## Holiday home specification:

Dimensions: 36' x 12'

Bedrooms: 2

**Sited on pitch 139**

**Price: £65,500**

## Highlights:

- **Wooden decking included**
- Beautifully appointed shaker style kitchen
- Feature log effect fire and surround
- Shower en-suite

**Siting, connection and transport charges are included**

## What we think of the 'ABI Wimbledon' here at Eastham Hall Holiday Park:

"A true home from home, comfortable and modern."