

ABI Ambleside Premier 2023

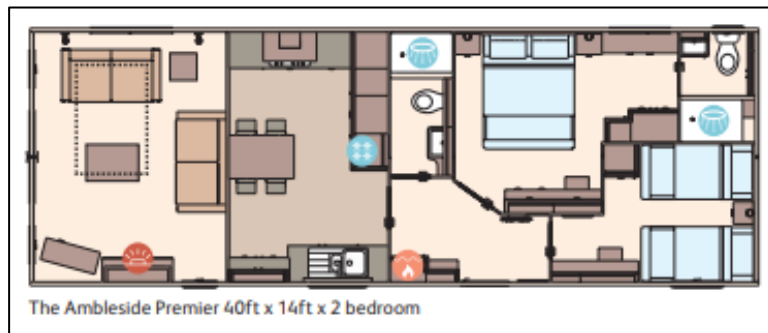

With grand proportions throughout, subtle taupe grey and wood finishes, the Ambleside is the perfect place to entertain, relax and unwind. And if you want a kitchen that's the heart of the home, look no further.

Holiday home specification:

Dimensions: 40' x 14'

Residential specification

Bedrooms: 2

Sited on pitch 107 – The Square

Price: £118,000

Highlights:

- **Very large composite decking to the front and side**
- Stunning kitchen with integrated appliances
- King sized bed plus 3' beds in twin room
- Entry hall
- Shower en-suite

Siting, connection and transport charges are included

What we think of the 'ABI Ambleside Premier' here at Eastham Hall Holiday Park:

"A simply stunning and spacious holiday home, with luxurious comfort which is perfect for families."